

SHIMANO NEXUS 3-SPEED HUB w/Coaster Brake

SG-3C40 Inter-3 Hub

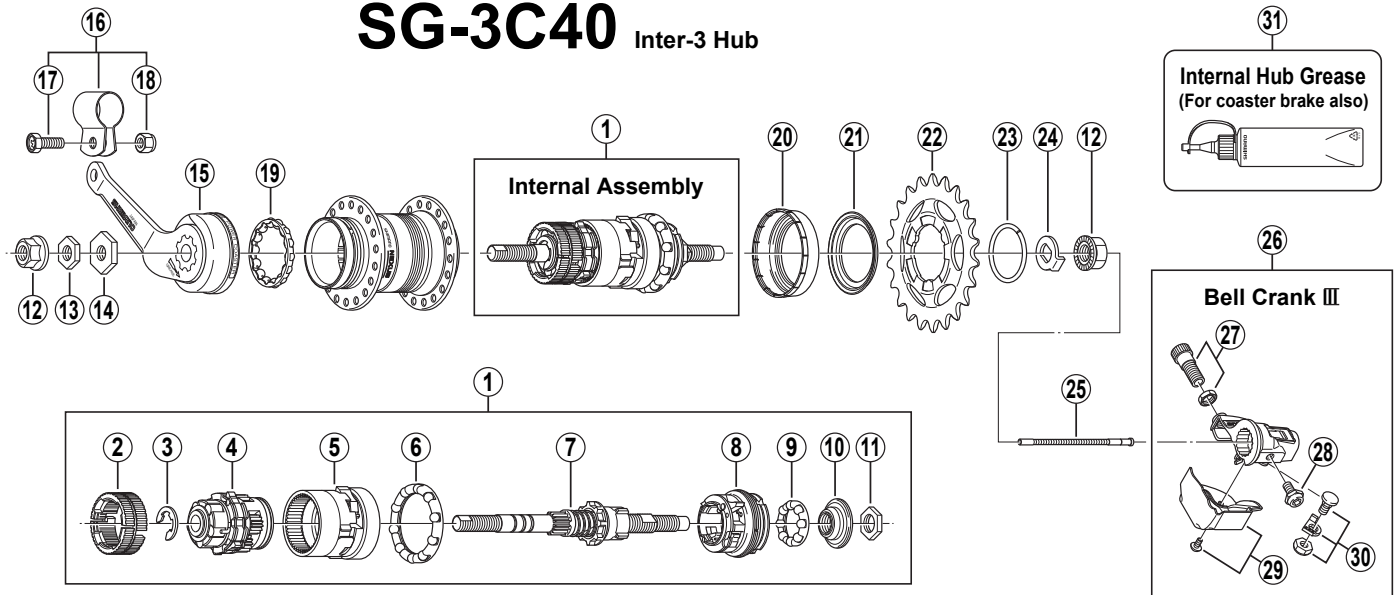

	Q'TY	ITEM NO.	SHIMANO CODE NO.	DESCRIPTION
		*	Y-33R 90100	Internal Assembly (Axle Length 168 mm)
		* 1	Y-33R 90120	Internal Assembly (Axle Length 175 mm)
		*	Y-33R 90130	Internal Assembly (Axle Length 178 mm)
		2	Y-33R 90600	Brake Shoe Unit
		3	Y-325 32000	Stop Ring (φ9 mm)
		4	Y-33R 90700	Carrier Unit
		5	Y-33R 90800	Ring Gear Unit
		6	Y-33R 90220	Ball Retainer K (7/32" x 10)
		*	Y-33R 98010	Axle Unit (Axle Length 168 mm)
		* 7	Y-33R 98060	Axle Unit (Axle Length 175 mm)
		*	Y-33R 98070	Axle Unit (Axle Length 178 mm)
		8	Y-33R 90400	Driver Unit
		9	Y-33R 90210	Ball Retainer J (7/32" x 8)
		10	Y-33R 90500	Right Hand Cone w/Dust Seal
		*	Y-33R 08010	Right Hand Lock Nut (3 mm) for Axle Length 168 mm / 178 mm
		* 11	Y-325 30300	Right Hand Lock Nut (7.7 mm) for Axle Length 175 mm
		12	Y-220 15010	Flange Nut
		*	Y-33R 49010	Left Hand Lock Nut (3 mm) for Axle Length 168 mm / 178 mm
		* 13	Y-33R 49020	Left Hand Lock Nut (5 mm) for Axle Length 175 mm
		* 14	Y-33R 48010	Stop Nut (3 mm)
		15	Y-33R 90900	Brake Arm Unit
		*	Y-33F 98090	Brake Arm Clip Unit (5/8")
		* 16	Y-33F 98100	Brake Arm Clip Unit (3/4")
		* 17	Y-75M 06000	Clip Screw (M6 x 16)
		* 18	Y-317 27200	Clip Nut
		19	Y-33R 90200	Ball Retainer L (3/16" x 14)
		20	Y-33R 05000	Right Hand Dust Cap A
		* 21	Y-33R 52001	Right Hand Dust Cap B
		*	Y-322 03200	Sprocket Wheel 16T (Black)
		*	Y-73T 21830	Sprocket Wheel 18T (Black)
		*	Y-73T 21930	Sprocket Wheel 19T (Black)
		* 22	Y-73T 22030	Sprocket Wheel 20T (Black)
		*	Y-73T 22130	Sprocket Wheel 21T (Black)
		*	Y-73T 22230	Sprocket Wheel 22T (Black)
		*	Y-73T 22330	Sprocket Wheel 23T (Black)
		* 23	Y-321 20010	Snap Ring C
		* 24	Y-33R 50010	Non-turn Washer
		*	Y-33R 98080	Push Rod (81.85 mm) for Axle Length 168 mm
		* 25	Y-33S 98180	Push Rod (86.85 mm) for Axle Length 175 mm / 178 mm
		26	Y-33S 95100	Bell Crank III Unit
		27	Y-33S 98010	Cable Adjusting Bolt & Nut
		28	Y-33S 57000	Bell Crank Body Fixing Bolt
		29	Y-33S 98020	Bell Crank Cover & Fixing Screw
		30	Y-33S 98030	Inner Cable Fixing Bolt Unit
		* 31	Y-041 20600	Internal Hub Grease (Net. 100g)